

HÔTEL BARRIÈRE
Fouquet's
NEW YORK



EXPERIENCE LA VIE EN ROUGE IN THE HEART OF TRIBECA

THE HOTEL

Blending Parisian panache with Tribeca cool, the hotel delivers sophisticated hospitality on an intimate scale. It features rooms and suites by world-renowned designer Martin Brudnizki and interiors that marry French elegance and downtown playfulness.

AMENITIES

24hr In-Room Dining | Valet Parking | High-speed Wi-Fi
Spa Diane Barrière with Pool, Steam Room, and Sauna
available for guest use | DOGPOUND Fitness Center
Meeting & Event Space | Cannes Cinema

ACCOMMODATIONS

Hotel Barrière Fouquet's New York features 97 residential-style guest rooms and suites including 66 Rooms, 31 Suites, an expansive Penthouse Suite.

The signature and distinctly French lavender color is incorporated throughout the guestroom design and the custom wallpaper displays whimsical scenes from Tribeca in a traditional toile de joup pattern, bridging Paris and New York.



IN-ROOM FEATURES

Complimentary Premium Wi-Fi | Personal In-Room Safe
 In-Room MiniBar Stocked with Snacks and Beverages | I-Pad
 for Hotel Services and In-Room Dining | Concierge Services
 Signature Barrière Toiletries | Packing and Unpacking Services
 Wake-up Calls | Stearns & Fosters Haraway Soft Mattresses
 Devialet Phantom Speakers | 50-inch and 55-inch LG TVs in
 the Bedrooms and Living Rooms

SPA DIANE BARRIÈRE

Dedicated to beauty and wellness, Spa Diane Barrière uses the expertise of the famous French dermo-cosmetics brand Biologique Recherche to provide a best-in-class spa experience. The Spa features a relaxation pool, five treatment rooms (including one couples treatment room), a sauna and a steam room.

CANNES CINEMA & MEETING ROOMS

The beautiful Cannes Cinema can be used for film premieres, special screenings, corporate launches, and other special events. The event spaces also include a large pre-function room and two large meeting rooms and can be combined to create a large banquet space or boardroom.

DOGPOUND GYM

The hotel also features a gym with cutting edge Technogym equipment and the very best personal trainers in the city for a bespoke workout. Hotel guests have access to in-gym and virtual personal training.

RESTAURANTS & BARS

Fouquet's New York is located on the hotel's ground floor and cloaked in the immediately recognizable red and black color palette, the signature restaurant is a reimagining of the original Fouquet's Paris inflected with New York City joie de vivre.

Tucked between Fouquet's and the guest reception is the Tirsou Bar. It was inspired by Bar Marta, the famed speakeasy at Hotel Barrière Fouquet's Paris.

Par Ici Café, the hotel's vegetable-focused café, has a menu honoring the Slow Food approach, highlighting fresh seasonal and organic ingredients sourced from fair-trade cooperatives, farms and small producers.

Le Vaux is a sprawling rooftop space inspired by the French gardens of Vaux-Le-Vicomte and Versailles. Designed by Martin Brudnizki, Le Vaux continues the property's signature Art-Deco aesthetic with an unmistakably French palette of lavender-green hues and furnishings, instantly transporting guests to a Parisian garden. Le Vaux is for the enjoyment of hotel guests and members only. Le Vaux is a seasonal destination open from May to September.

GUEST ROOMS	ROOM SIZE (ft ² / m ²)	TERRACE SIZE (ft ² / m ²)	INVENTORY
Courtyard Room	333 / 31	-	16
Deluxe King / Deluxe Double Queen	344-387 / 32-36	-	14
ADA Deluxe Room	344-387 / 32-36	-	1
Prestige King / Prestige Double Queen	344-387 / 32-36	-	34
ADA Prestige King	344-387 / 32-36	-	1
Junior Suite	420-452 / 39-42	-	9
ADA Junior Suite	420-452 / 39-42	-	1
Prestige Junior Suite	484 / 45	-	5
Tribeca Corner Suite	764 / 71	-	5
Hudson View Corner Suite	731 / 68	-	5
Tribeca Terrace Suite	613-656 / 57-61	511-534 / 48-50	2
Tribeca Corner Terrace Suite	753 / 70	791 / 65	1
Hudson View Corner Terrace Suite	688 / 64	819 / 76	1
Fouquet's Corner Terrace Suite	764 / 71	1682 / 156	1
Fouquet's 2-Bedroom Penthouse	1912 / 178	1235 / 115	1
Fouquet's 3-Bedroom Penthouse	2674 / 248	1435 / 133	1

GUEST ROOM FLOORPLANS

COURTYARD ROOM



DELUXE KING/DELUXE DOUBLE QUEEN



PRESTIGE KING/ PRESTIGE DOUBLE QUEEN



JUNIOR SUITE



PRESTIGE JUNIOR SUITE



TRIBECA CORNER SUITE



HUDSON VIEW CORNER SUITE



TRIBECA TERRACE SUITE



GUEST ROOM FLOORPLANS

TRIBECA CORNER TERRACE SUITE



FOUQUET'S PENTHOUSE

MAIN FLOOR



HUDSON VIEW CORNER TERRACE SUITE



UPPER FLOOR 3-BEDROOM



UPPER FLOOR 2-BEDROOM

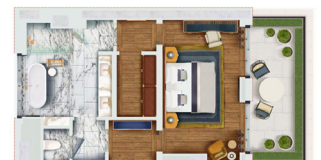

FOUQUET'S CORNER TERRACE SUITE

